



AC Contactors - Bulletin 7707 TM

1-Pole, Single Phase									
NEMA Size	Maximum Motor Horsepower Rating			Starter Amps. Continuous	NEMA Type 1 General Purpose Enclosure Catalog No.	NEMA Type 4 Watertight Enclosure Catalog No.	NEMA Type 12 Industrial - Dust-tight Enclosure Catalog No.	Open Type	
	115V	200V	230V					Catalog No.	
00	1/3	----	1	9	T77A01A - *	Use Size 0	Use Size 0	T77U01A - *	
0	1	----	2	18	T77A010 - *	T77W010 - *	T77T010 - *	T77U010 - *	
1	2	----	3	27	T77A011 - *	T77W011 - *	T77T011 - *	T77U011 - *	
2 Pole, Single Phase									
00	1/3	----	1	9	T77A02A - *	Use Size 0	Use Size 0	T77U02A - *	
0	1	----	2	18	T77A020 - *	T77W020 - *	T77T020 - *	T77U020 - *	
1	2	----	3	27	T77A021 - *	T77W021 - *	T77T021 - *	T77U021 - *	
2	3	----	7 1/2	45	T77A022 - *	T77W022 - *	T77T022 - *	T77U022 - *	
3	7 1/2	----	15	90	T77A023 - *	T77W023 - *	T77T023 - *	T77U023 - *	
3 Pole, Three Phase									
NEMA Size	200V		460-575V	Continuous					
	1 1/2	1 1/2	2					Catalog No.	
00	1 1/2	1 1/2	2	9	T77A03A - *	Use Size 0	Use Size 0	T77U03A - *	
0	3	3	5	18	T77A030 - *	T77W030 - *	T77T030 - *	T77U030 - *	
1	7 1/2	7 1/2	10	27	T77A031 - *	T77W031 - *	T77T031 - *	T77U031 - *	
2	10	15	25	45	T77A032 - *	T77W032 - *	T77T032 - *	T77U032 - *	
3	25	30	50	90	T77A033 - *	T77W033 - *	T77T033 - *	T77U033 - *	
4	40	50	100	135	T77A034 - *	T77W034 - *	T77T034 - *	T77U034 - ² *	
5	75	100	200	270	U77A035 ² - *	U77W035 ² - *	U77T035 ² - *	U77U035 - *	
6	150	200	400	540					
4 Pole, Three Phase									
0	3	3	5	18	T77A040 - *	T77W040 - *	T77T040 - *	T77U040 - *	
1	7 1/2	7 1/2	10	27	T77A041 - *	T77W041 - *	T77T041 - *	T77U041 - *	
2	10	15	25	45	T77A042 - *	T77W042 - *	T77T042 - *	T77U042 - *	
3	25	30	50	90	T77A043 - *	T77W043 - *	T77T043 - *	T77U043 - *	
4	40	50	100	135	T77A044 - *	T77W044 - *	T77T044 - *	T77U044 - *	
5	75	100	200	270					
6	150	200	400	540					

Consult Factory or See Vacuum Contactors in Section A
Consult Factory or See Vacuum Contactors in Section A

Note: 1. Price includes contactor complete with one N.O. control-circuit contact.
2. This unit replaces T77 (size 5) and is not interchangeable.

Ordering Information

● Use complete catalog number. Replace the (*) with the suffix from coil table.

Coil Volt/Hertz

Suffix

24/60 or 24/50	-96
110-120/60 or 110/50	-76
220-240/60 or 220/50	-26
440-480/60 or 440/50	-46
550-600/60 or 550/50	-56
200-208/60	-86

Auxiliary Contacts -Auxiliary contact blocks may be added with the starter in place, without tools. The same block is used on sizes 00 thru size 4 as either N.O. or N.C.. A total of 4 auxiliary contacts can be added. The addition of side mounting kits allows a total of 8 auxiliary contacts through size 4.

Operating Coils - All coils are encapsulated. Size 00 thru 4 are plug-in type and each is factory tested twice, for long reliable service. Coil changes are not required for any combination of add-on accessories.

Power Wiring - Up-front terminals and straight through design make power wiring easy. As few as 3 connection points per pole reduces the possibility of loose connections and contributes to the reliability of the starter.

Power Pole - Full rated power poles, N.O. or N.C. through NEMA size 4, may be field added, without coil change. A tie pole with 2 N.O. contacts is available for two-speed single winding (consequent pole) motor applications.

Contact Inspection - Loosen 2 captive screws and remove the contact carrier, through size 4.

Adapter Plate - Allows use of Type TM starters in place of other make s thru size 2, without drilling new mounting holes. The adapter plate holes align with those of most other starters thru size 2 - proof of the TM compact design.

Overload Relay - Available with ambient compensation (green reset rod) or non-ambient compensation (red reset rod). An easily accessible + 15, adjustment knob can be locked at the 100% setting. High accuracy of repetitive trip is assured by factory testing every unit twice.

Heaters - Heater numbers are stamped on the surface for easy identification. The same heaters are used for TM & HP series overload relays for both ambient and non-ambient compensated overload relays.

Reliability - The basic contactor design, using polysulphone and teflon guides, melamine and rosite moldings along with stainless steel springs, provides exceptional electrical and mechanical life. The operating state is clearly visible from the front, indicated by the position of the contact carrier. The contactor is easily operated from the front for circuit checking.

Versatility - ●Uniform mounting dimensions ●Add-on auxiliary contacts ●Plug-in coils Accessories, such as power pole, mechanical interlock pro-vides maximum versatility and flexibility of inventory panel layout and installation. Self-rising saddle-clamps are included on all control terminals for quick wiring.

NEMA Open Type, Type 1, 4 & 12

Open Type		Dimensions - inches				
NEMA Size	Poles	Wide	High	Deep	Mounting	
		A	B	C	D	E
00	3	3 7/8	4 1/4	4 5/8	3 3/4	1 1/2
0-1	1-3	3 7/8	4 1/4	4 5/8	3 3/4	1 1/2
0-1	4	4 7/8	4 1/4	4 13/16	3 3/4	1 1/2
2	2-3	3 7/8	4 1/4	4 15/16	3 3/4	1 1/2
2	4	4 7/8	4 1/4	4 15/16	3 3/4	1 1/2
3-4	2-3	5 7/16	8 1/8	7 1/16	6 7/8	3 1/2
3-4	4	6 15/16	8 1/8	7 1/16	6 7/8	3 1/2
5	2-3	8 3/4	12 1/4	9 1/2	11 1/2	7
6		See Section A				
Type 1						
00	3	6 3/4	9 1/2	6 1/4	7 3/4	5
0-2	1-4	6 3/4	9 1/2	6 1/4	7 3/4	5
3-4	2-4	12	22	9	19	9
5	2-3	22	49	11 3/8	47 1/2	18
6		See Section A				
Type 1 (with transformer)						
00	3	12 5/8	9 1/2	6 1/4	7 3/4	11
0-2	1-4	12 5/8	10 1/8	6 1/4	9 1/2	11
3-4	2-4	12	22	9	19	9
5	2-3	22	49	11 3/8	47 1/2	18
6		See Section A				
Type 4						
00	3	7 1/4	11	6 7/8	10 1/2	4 ¹
0-1	1-4	7 1/4	11	6 7/8	10 1/2	4 ¹
2	2-4	7 1/4	11	6 7/8	10 1/2	4 ¹
3	2-4	12 1/4	24 5/8	9 3/16	23 1/2	7 ¹
4	2-4	12 1/4	24 5/8	9 3/16	23 1/2	7 ¹
5	2-3	17	49	11 3/8	47 1/2	18
6		See Section A				
Type 4 (with transformer)						
00	3	13 1/8	11	6 7/8	10 1/2	6
0-1	1-4	13 1/8	11	6 7/8	10 1/2	6
2	2-4	13 1/8	11	6 7/8	10 1/2	6
3	2-4	12 1/4	24 5/8	9 3/16	23 1/2	7 ¹
4	2-4	12 1/4	24 5/8	9 3/16	23 1/2	7 ¹
5	2-3	17	49	11 3/8	47 1/2	18
6		See Section A				
Type 12						
00	3	7 1/4	11	6 15/16	10 1/2	4 ¹
0-2	1-4	7 1/4	11	6 15/16	10 1/2	4 ¹
3-4	2-4	12 1/4	24 5/8	9 3/16	23 1/2	7 ¹
5	2-3	22	49	11 3/8	47 1/2	18
6		See Section A				
Type 12 (with transformer)						
00	3	13 1/8	11	6 15/16	10 1/2	6
0-2	1-4	13 1/8	11	6 15/16	10 1/2	6
3-4	2-4	12 1/4	24 5/8	9 3/16	23 1/2	7 ¹
5	2-3	22	49	11 3/8	47 1/2	18
6		See Section A				

¹One top mtg. keyhole on center line.

Magnetic Contactors

Open Type

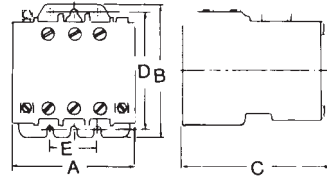

NEMA Type 1

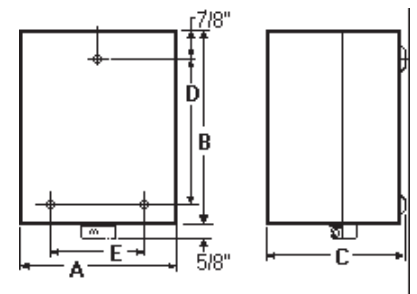

NEMA Type 4

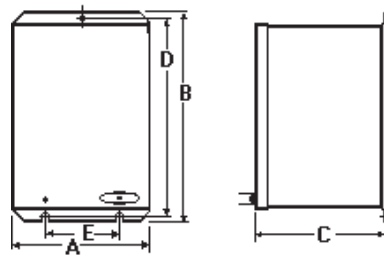

NEMA Type 12

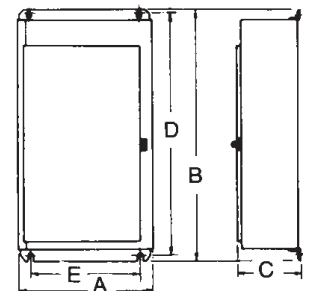

Conduit Hub Size and Location

Encl. Size	Top & Bottom	Bottom Only	H	J	K
			00-1	3/4	3/4
2	1 1/2	3/4	3	1 5/8	1 5/8
3	2	3/4	3	2	2
4	2 1/2	3/4	3	2	2
5	3	3/4	5	3	3